

Ref No	Description	Part Number	Notation	Qty Reqd
00	INSULATION	1894472		
00	NUT-LOCK	830288		
00	INSULATION	830489		
01	HOUSING-RECTIFIER	1876762		1
02	ROTOR ASSY	1968904		1
03	STATOR ASSY	1876804		1
04	FRAME-DE	1852726		1
05	REGULATOR	1116433		1
06	DIODE TRIO	1876797		1
07	RECTIFIER BRIDGE ASSY	1875645		1
08	FIELD COIL & SUPPORT ASSY	1974630		1
09	ROLLER BEARING	9436064	Outer Race & Roller - Rectifier End	1
10	RACE-ROLLER BEARING	NA	Inner Race & Roller - Rectifier End	1
11	BALL BEARING ASSY	10472935		1
12	CAPACITOR ASSY	10474443		1
13	SERV PKG, BATTERY TERM	1876897		1
14	RELAY TERMINAL	1971673		1
15	SCREW	9427129		1
17	LEAD ASSY	1876809	Bridge to Relay	1
18	LEAD ASSY	1876807	Bridge to Regulator Mtg. Screw	1
21	RETAINER/D.E. BEARING	10497221		1
22	FAN	1969481		1
24	LOCK WASHER-GROUND SCREW	STD HWD		1

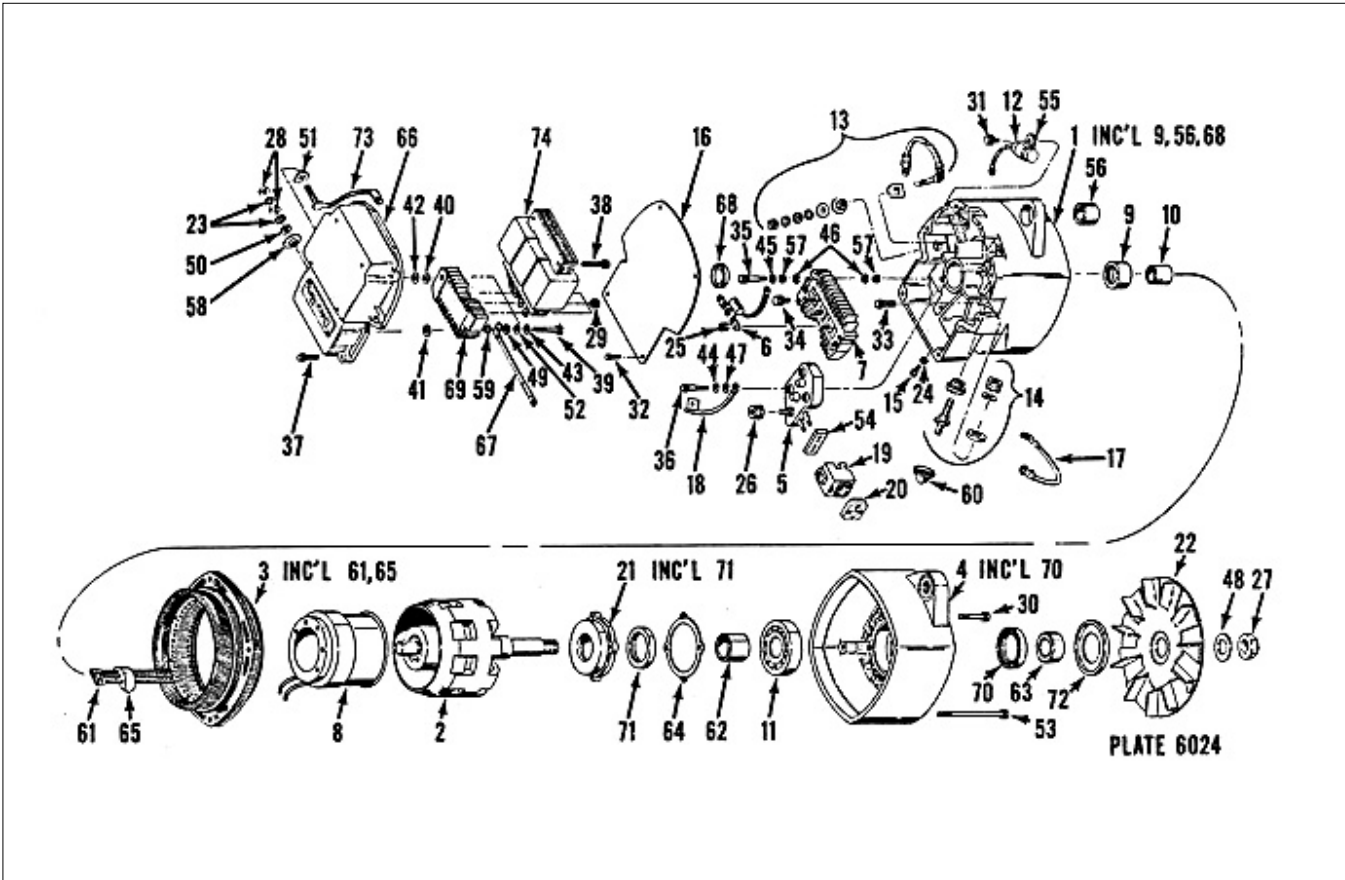

Ref No	Description	Part Number	Notation	Qty Reqd
25	NUT ASSY	1851808		1
26	NUT ASSY	1851808	Bridge Term Stud	3
27	NUT-ROTOR SHAFT-D.E.	10484823		1
30	SCREW ASSY	10497222		4
31	SCREW ASSY	1846955	Atch. Capacitor	1
33	SCREW	1968945	Field Coil & Support Atch.	5
34	SCREW ASSY	1846955	Atch. Connector to Bridge	2
35	SCREW ASSY	830338	Rectifier Bridge Atch.	2
36	SCREW ASSY	1976061	Regulator Atch. (Insul.)	2
37	SCREW ASSY	830741		6
38	SCREW ASSY	1846957		4
39	SCREW ASSY	830338		2
41	WASHER	815540		2
48	WASHER-SHAFT NUT	10484823		1
53	THRU BOLT	1968991		4
54	BOOT	1876806		1
56	BUSHING	1892765		1
58	BUSHING	1944973		1
59	BUSHING	1894463		1
60	CAP	1970227	Relay Term	1
61	CLIP-TERMINAL	1966797		3
62	COLLAR (INSIDE)-SPACE-D.E. BEARING	10497218	(Inside) Space - DE Bearing	1
63	COLLAR (OUTSIDE)-SPACE-D.E.	1968890	(Outside) Space - DE Bearing	1

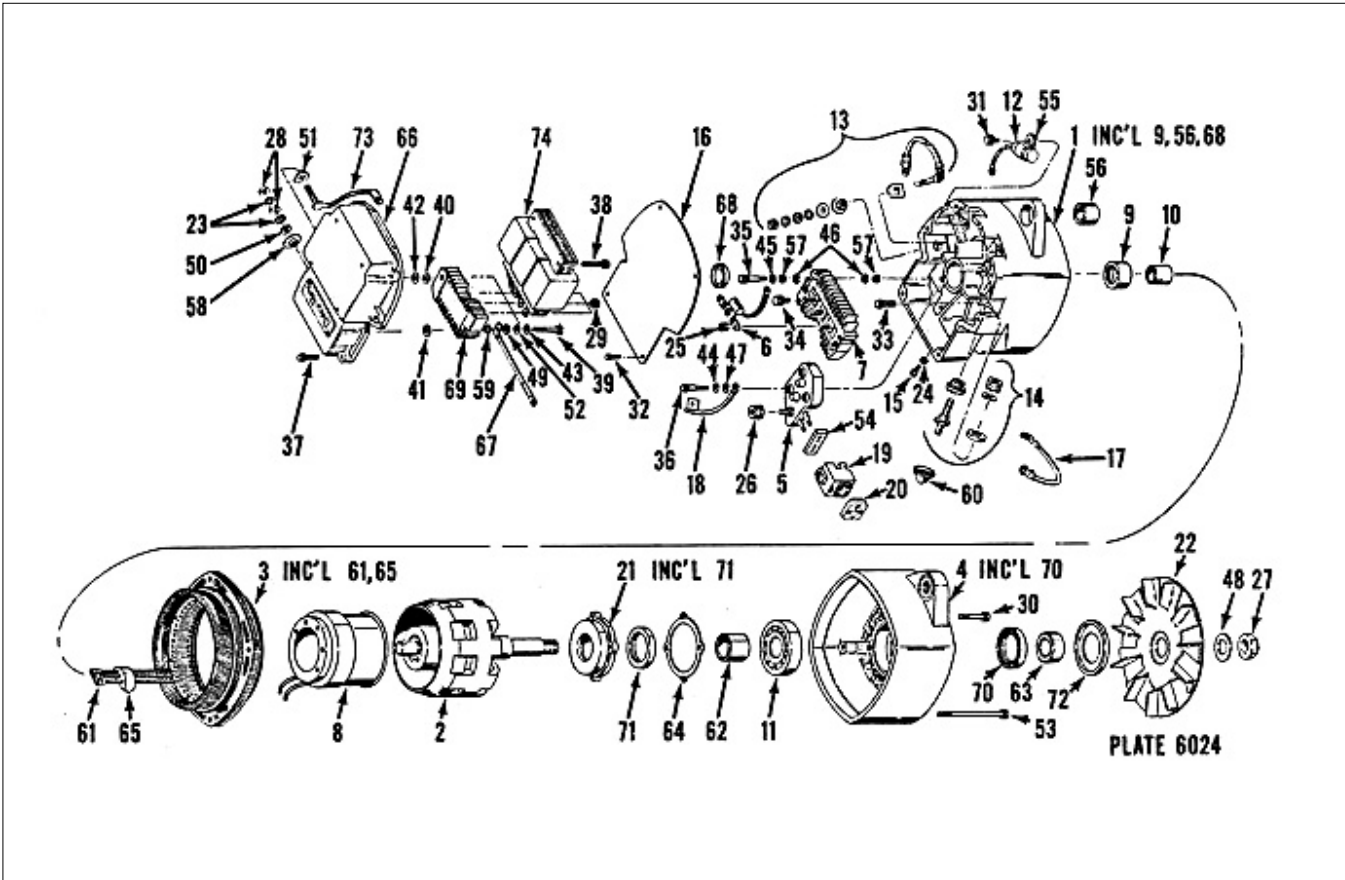

Ref No	Description	Part Number	Notation	Qty Reqd
64	GASKET	1968884		1
65	GROMMET	1876805		1
66	HOUSING	830285		1
68	PLUG-BEARING WELL	1876813		1
69	RECTIFIER ASSY	1984638		1
70	SEAL-OIL	1958509	SEAL-DE Brg. (Outside)	1
71	SEAL-OIL	1958509	SEAL-DE Brg. (Inside)	1
72	SLINGER-GREASE-D.E.	1968891		1
73	TERM. STUD & LEAD-TRANSFORMER	1894712		1
74	TRANSFORMER ASSY	1979131		1